

Tyne Amateur Rowing Club
Course & safety map 4500m
Event: Rutherford Head
Event date: 27 November 2021
 As at 27-10-21

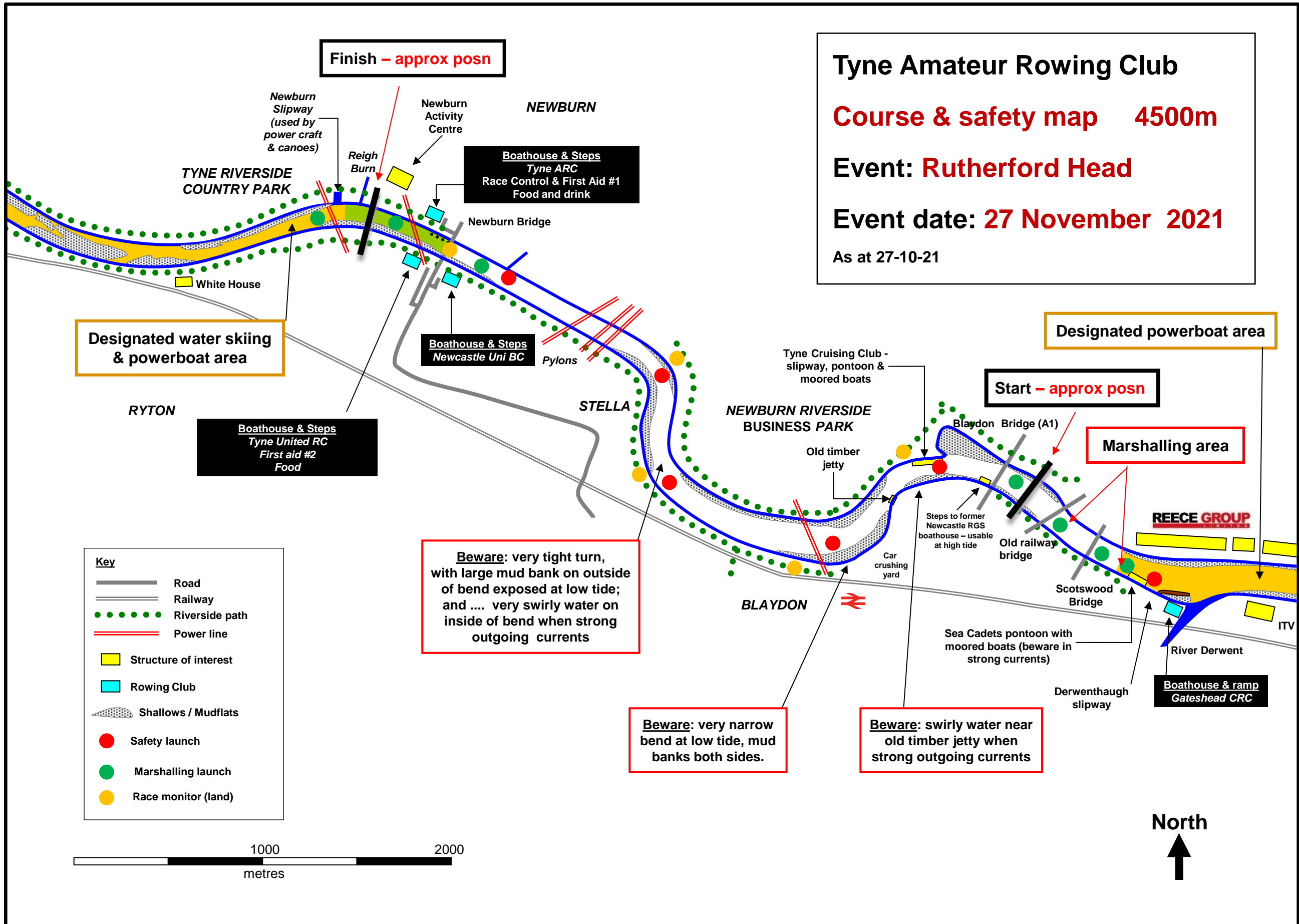

Finish – approx posn

Start – approx posn

Marshalling area

Beware: very tight turn, with large mud bank on outside of bend exposed at low tide; and ... very swirly water on inside of bend when strong outgoing currents

Beware: very narrow bend at low tide, mud banks both sides.

Beware: swirly water near old timber jetty when strong outgoing currents

Designated water skiing & powerboat area

Designated powerboat area

- Key**
- Road
 - Railway
 - Riverside path
 - Power line
 - Structure of interest
 - Rowing Club
 - Shallows / Mudflats
 - Safety launch
 - Marshalling launch
 - Race monitor (land)

