

Tyne Head - 11 February 2023

Course map 4.5km

As issued 01-02-23

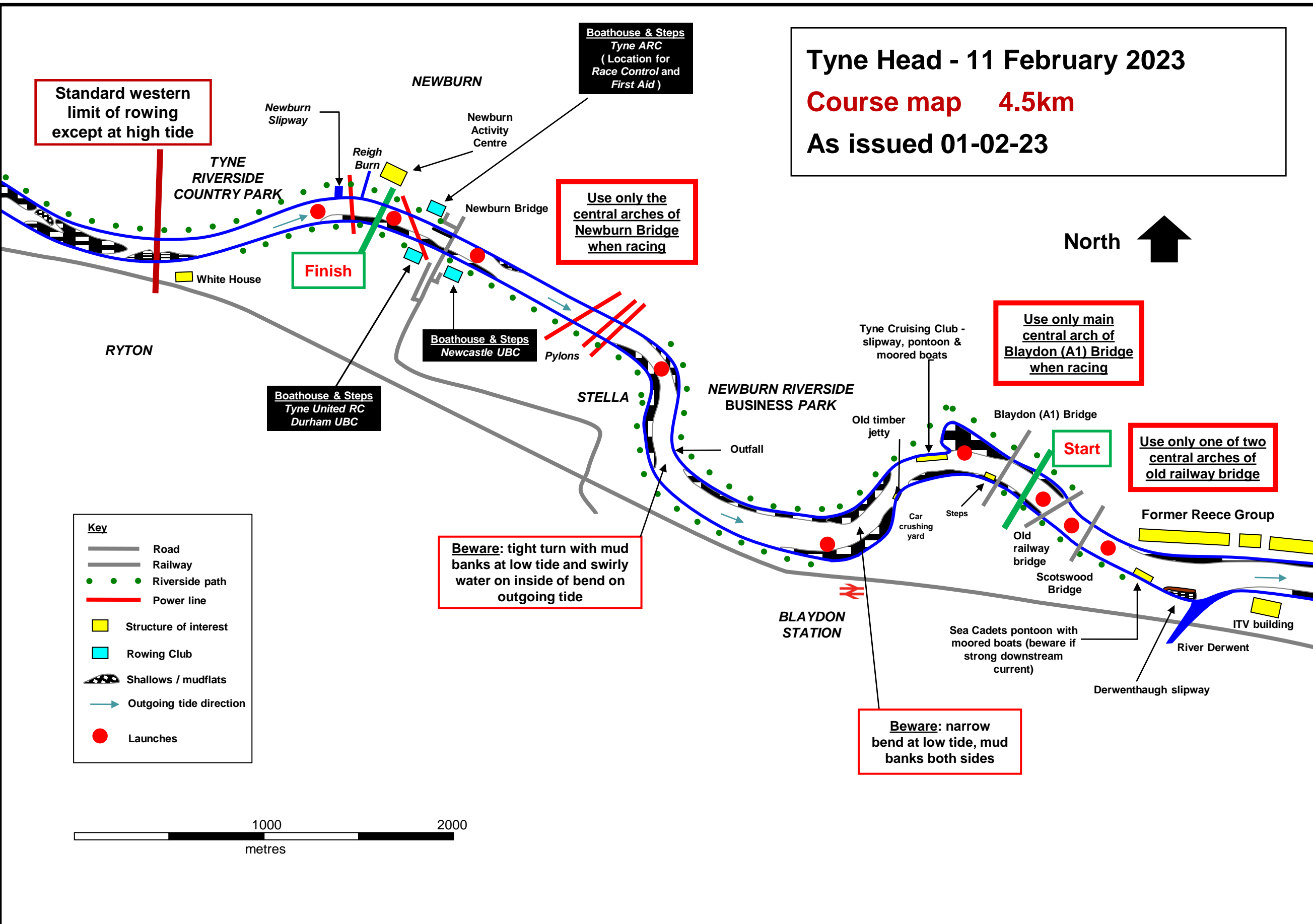

Standard western limit of rowing except at high tide

Finish

Use only the central arches of Newburn Bridge when racing

Use only main central arch of Blaydon (A1) Bridge when racing

Use only one of two central arches of old railway bridge

Start

Beware: tight turn with mud banks at low tide and swirly water on inside of bend on outgoing tide

Beware: narrow bend at low tide, mud banks both sides

Key	
	Road
	Railway
	Riverside path
	Power line
	Structure of interest
	Rowing Club
	Shallows / mudflats
	Outgoing tide direction
	Launches

