

# Tyne Amateur Rowing Club

**Course & safety map - 4500m**

**Event: Rutherford Head**

**Event date: 01-12-18** Draft V1 issued 18-10-18

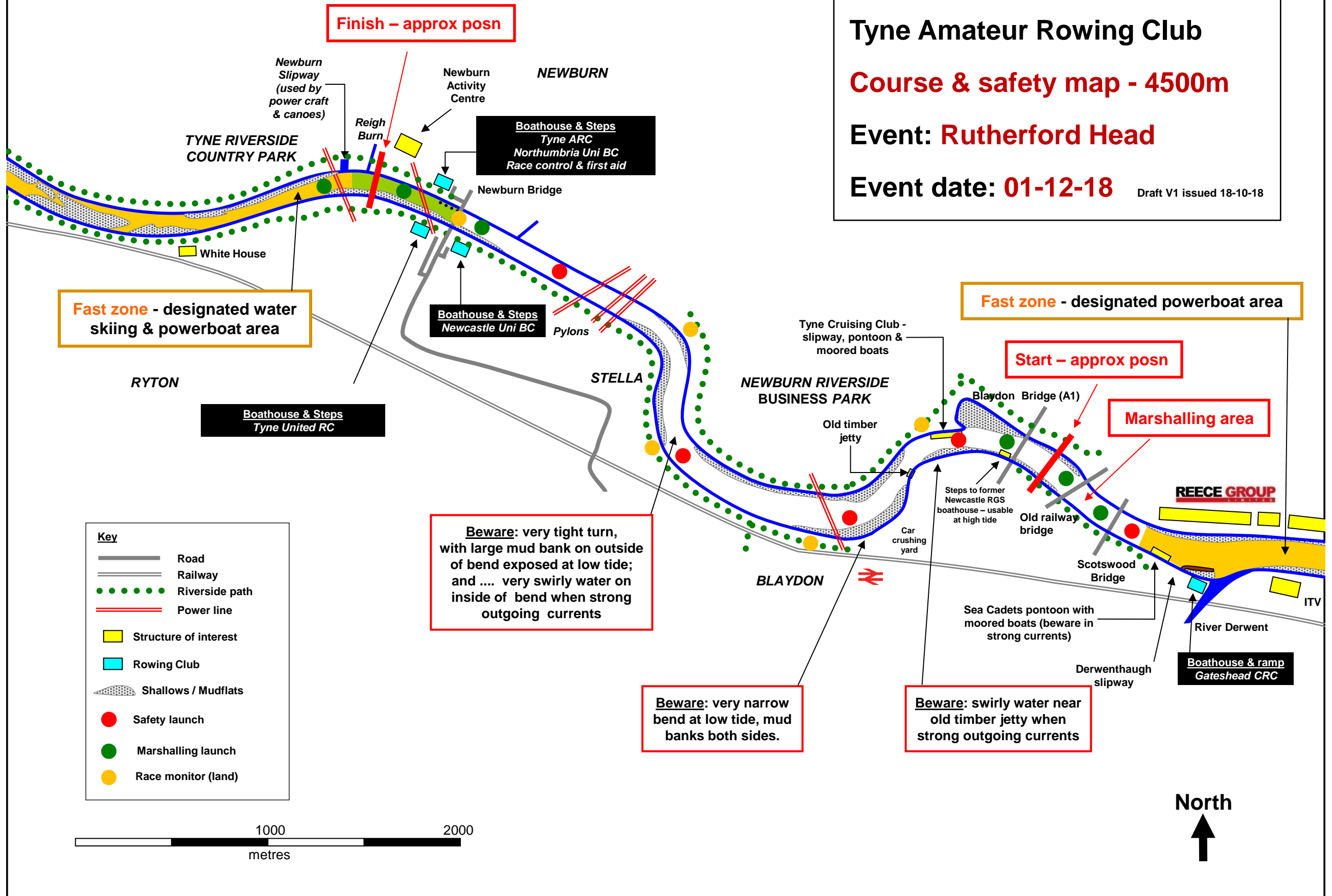

**Finish – approx posn**

**Start – approx posn**

**Fast zone - designated water skiing & powerboat area**

**Fast zone - designated powerboat area**

**Marshalling area**

**Beware: very tight turn, with large mud bank on outside of bend exposed at low tide; and .... very swirly water on inside of bend when strong outgoing currents**

**Beware: very narrow bend at low tide, mud banks both sides.**

**Beware: swirly water near old timber jetty when strong outgoing currents**

**Key**

- Road
- Railway
- Riverside path
- Power line
- Structure of interest
- Rowing Club
- Shallows / Mudflats
- Safety launch
- Marshalling launch
- Race monitor (land)

